



'NEW FEATURE'
SETA_HP Series



Product Code	Product Model and Type	SETA_HP 24-60W
Electrical (Input Value)	Power (Watt)	24-35-60W
	Voltage (VAC)	100-277 VAC
	Power Factor (PF)	≥ 0.95
	Amper (A)	Max. 700mA
	Frequency Interval (Hz)	50/60 Hz
	Driver Brand	GigaTera
	Driver Origin	Designed in Korea
	Maximum Load THD (Total Harmonic Distortion) Value	20%
	Surge Protection (kV) (Inside Driver)	6kV
	Driver Lifetime	50,000 Hours
	Driver Efficiency	≥ %94
	Driver Case Temperature under Operation	39.3°C (@25°C Ambient)
	Driver Case Temperature under Operation	90°C
	Surge Protection (kV)	20kV
Control Type (Optional)	Wireless Zigbee, 1-10V, Autodimming, Half Night Switch (HNS)	

Photometrics

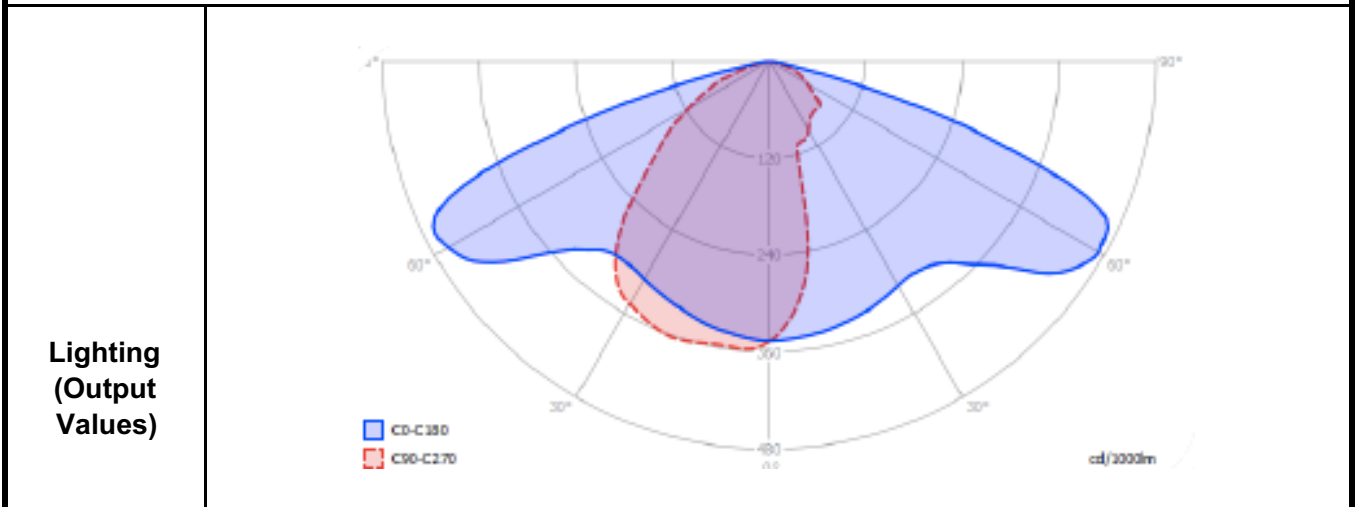

**Lighting
(Output Values)**

Total Lumen Output	3,240 - 4,725 - 8,100lm ±10%
Lumen Efficacy (Lumen/Watt)	>135lm/w
Color Temperature (Kelvin)	4000K (5700K, 3000K)
Color Rendering Index (Ra)	≥ 70
Lens, Reflector Material	GigaTera Lens
UGR Rating	< 30
Beam Angle	120° Horizontal - 50° Vertical

EXPLODED VIEW OF THE PRODUCT PARTS

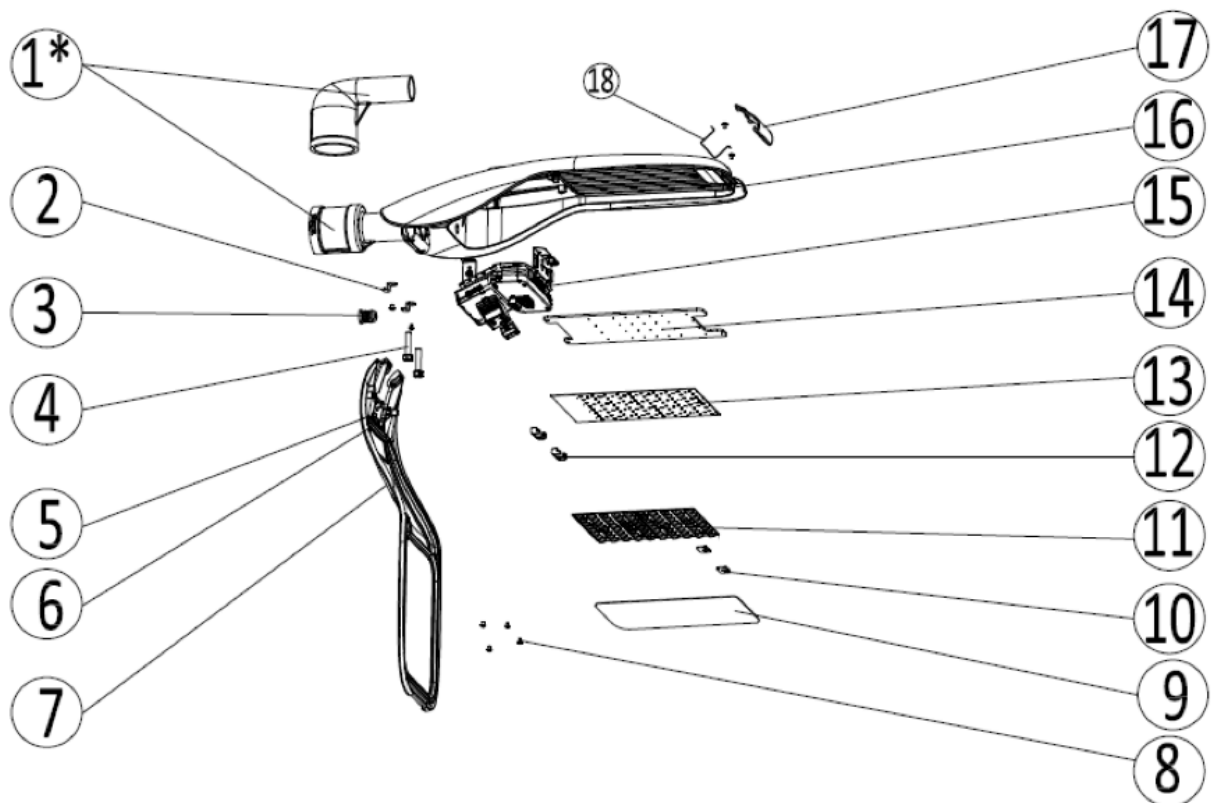

NO	DEFINITION	PIECE
1	POLE HOLDER (OPSIYONEL)	1
2	BOTTOM FIXING BRACKET	2
3	METAL RAKOR	1
4	SCREW M10X50 8.8 720H	2
5	BOTTOM CAPS PLASTIK	1
6	SPRIT LEVEL	1
7	BOTTOM AL ROAD (RAL 7040)	1
8	SCREW M3X6.5 TAPTITE ROHS	20
9	GLASS LED TEMPERED	1
10	PCP METAL FIXING BRACKET	2
11	LED LIGHTING LENS	20
12	PLASTIC CLIPS	2
13	PCB 001	1
14	PCB PLATE	1
15	POWER SUPPLY	1
16	TOP AL ROAD (RAL 7040)	1
17	METAL CLIPS	1
18	CLIPS WIRE ROADLIGHT	1

General Information	Luminaire Lifetime	Min. 50,000 Hours
	Luminaire Warranty	5 YEARS
	Luminaire Maximum Operational Temperature	+50 °C
	Luminaire Minimum Operational Temperature	-40 °C
	L70B50 Economical Lifetime	Min. 50,000 Hours
	LED Chip Brand	Cree
	LED Chip - Quantity	High Power LED - 20pcs (24w) / 40pcs (35/60w)
	Amper Level (Maximum Rating)	1500mA
	Amper Level used for Luminaire Design	700mA
	Mechanical Values	PCB Material
PCB Thermal Conductivity (W/mK)		≥ 2
Luminaire Front Glass Type and IK Level		Tempered Glass (4.0 mm) - IK08
Luminaire Heatsink Material		Aluminium Injection
Luminaire Heatsink Paint Type		Powder Coating - Gray
Detailed Information for Installation		35-60mm Pole Diameter (60-76mm Extra Adaptor Available)
IP Level		66
Dimensions: Width x Length x Height (mm) - Weight (kg)		295x599.6x134.6mm - 6.5kg
Box Dimensions		350x655x190mm
Quantity per Container 20ft / 40ft		210 / 420 pcs
Pallet Dimensions - Width - Legth - Height (cm)		115 x 166 x 160cm
Total Quantity over Pallet / Total Weight	40pcs / 260kg	

0°, 5°, 10°, 15° Tilt Angle Adjustable

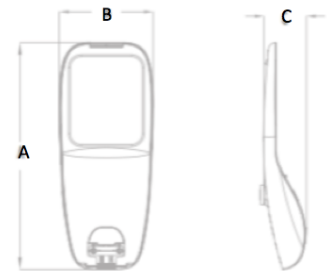
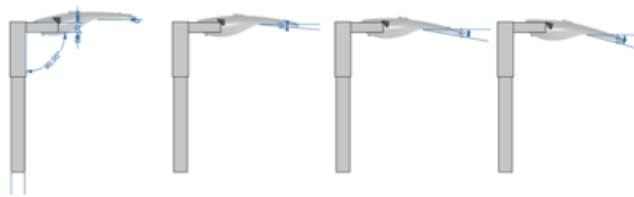

Wireless Dimming Values	Wireless Control Type	Zigbee (Optional)
	Input Voltage	15 Vdc
	Max. Electricity Consumption	0.36W (@15 Vdc)
	Standard	2.4 Ghz - IEEE 802.15.4
	Network	Mesh
	RF Tx Power	Max. +8 dBm (Tip. 5 dBm)
	Data Transfer Speed	250 kbps
	Security	128 bit AES Encryption Algorithm
	Dimming	PVM, 0-10 Vdc
	Antenna Type	Omni , 2 dBi

Certifications	Certifications (Country of Origin)	CE, ENEC, EMC (Europe)
-----------------------	------------------------------------	------------------------



GigaTera[®]
beyond light

GigaTera Inc.

HQ Office: 3 Dongtan Sandan, 6 Gil Bang Gyo Ri
Dongtan Myeon, Hwaseong City, Gyeonggi Do, Korea

W: www.gigateraled.com.tr
E: ledsales@gigateraled.com

GigaTera Aydınlatma San. ve Tic. A.Ş.

Turkey Office: Soğanlık Yeni Mah. Balıkesir Cad. Uprise Elite
C1AB Blok Kat:28 No:242, 34880 Kartal, İstanbul, Türkiye

T/F: +90 216 999 3578

W: www.gigateraled.com.tr
E: info@gigateraled.com.tr